

Enjoy the coming Season in the latest Motorhomes from Autotrail.

The new model Tribute T715 2-4 Berth Fixed Bed

The Spacious Autotrail Tribute coachbuilt Lo-Line model T715 Fixed Bed 2-4 berth is a luxury Ford based motor home with a 140bhp turbo diesel and 6 speed manual gearbox, that any driver could get used to. To complement this it has ABS brakes, cruise control, cab air conditioning and power steering.



Front facing belted seats

Rear Fixed Double bed



Specification

Length	6.95m(22' 9")
Width	2.27m(7' 5")
Height	2.75m (9' 0")
Fresh water	85ltrs
Waste	85ltrs

Berths	2 or 4 available
Dinette double	2.08m x 1.22m
Rear double	1.90m x 1.27m

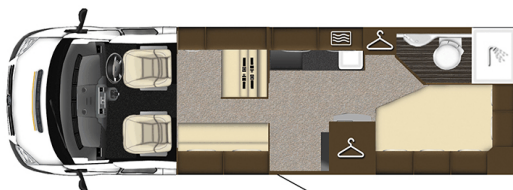

The Dinette area has an excellent layout having the daytime seating just behind the drivers cab making it easy to travel in total comfort.

Standard features included are:-

A full kitchen consisting of:

- A four burner hob, grill and oven
- Sink with hot and cold running water
- Refrigerator with freezer compartment
- Cutlery, crockery and cookware
- Fire blanket, extinguisher and first aid kit
- A bathroom with basin, hot-cold running water and separate shower
- An electric flushing cassette toilet c/w chemicals
- Curtains, blinds and flyscreens to all windows
- Gas/electric blown air heating
- Gas/electric water heater
- Dining table
- Leisure battery
- TV Aerial and booster unit
- Inboard fresh water tank and pump
- Onboard grey waste tank
- Gas regulator and two 7kg gas bottles
- Fresh water filler hose and 240v mains lead
- Radio CD player
- Heki Roof light
- Full seat belts for forward facing seats
- Central door locking
- Campsite guides

Additional extras are:-

Full colour reversing camera, 800w Microwave, 3 speed roof ventilator, pleated windscreen blind and exterior hot/cold shower point.

Also Available are:-

Portable satellite navigation system complete with hands free bluetooth phone technology;

LED Flat screen Terrestrial and Satellite TV with DVD player;

Bikes, Chairs, Sleeping bags etc.